



Push 15

Programming Guide

MT02-0101-XXX008_v1.1_20201116

1. ASSEMBLY

Please refer to separate Rollease Acmeda System Assembly Manual for full assembly instructions relevant to the hardware system being used.

2. BATTERY MANAGEMENT

For battery motors:
Prevent discharging the battery completely for extended periods, recharge as soon as the battery is discharged

CHARGING NOTES

Charge your motor for 6-8 hours, depending on the motor model, as per motor instructions

 During operation, if battery is low, the motor will beep 10 times to prompt the user it needs charging.

DISPOSAL AND RECYCLING

 Do not dispose of in general waste.



P1 LOCATIONS

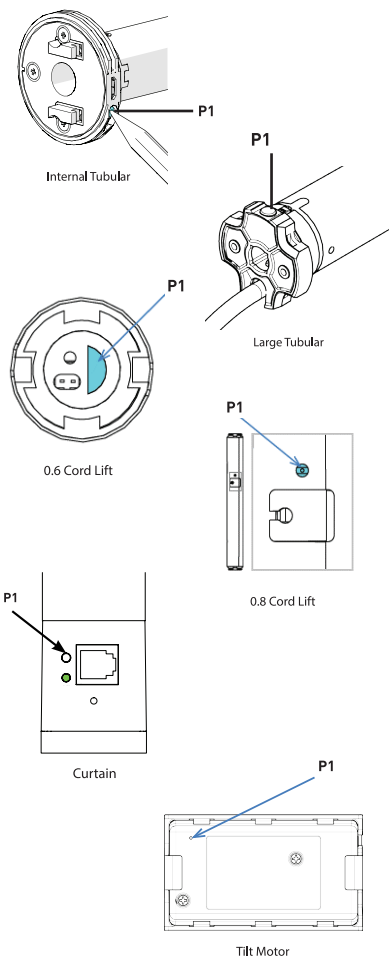

SAFETY

 **WARNING:** Important safety instructions to be read before installation and use.

Incorrect installation or use can lead to serious injury and will void manufacturer's liability and warranty. It is important for the safety of persons to follow the enclosed instructions. Save these instructions for future reference.

- Do not expose to water, moisture, humid and damp environments or extreme temperatures.
- Persons (including children) with reduced physical, sensory or mental capabilities, or lack of experience and knowledge, should not be allowed to use this product.
- Use or modification outside the scope of this instruction manual will void warranty.
- Installation and programming to be performed by a suitably qualified installer.
- Follow installation instructions.
- For use with motorized shading devices.
- Frequently inspect for improper operation. Do not use if repair or adjustment is necessary.
- Keep clear when in operation.
- Replace battery with correctly specified type.

 **WARNING:** Do not ingest battery, Chemical Burn Hazard.
This product contains a coin/button cell battery. If the coin / button cell battery is swallowed, it can cause severe internal burns in just 2 hours and can lead to death.
Keep new and used batteries away from children. If the battery compartment does not close securely, stop using the product and keep it away from children.
If you think batteries might have been swallowed or placed inside any part of the body, seek immediate medical attention.

BUTTON OVERVIEW

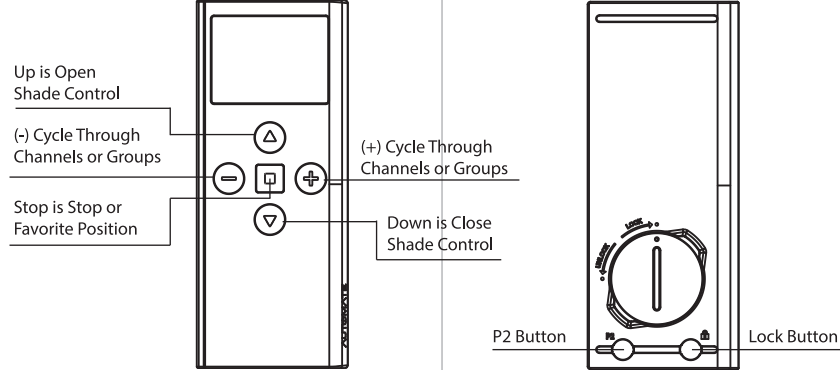

HOW TO CHARGE LH-ION ZERO WIRE-FREE MOTOR



STEP 1
Rotate cover cap to expose motor head

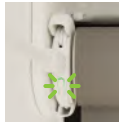

STEP 2
Find nearest power source and plug in charger (use an extension cord if required)



STEP 3
Plug micro USB end into the motor
- Observe the green light flashing and charge until the green light goes solid green
- Please note this may take up to eight hours depending on how flat your battery is
- Any mobile phone charger can also be used to charge your motor

STEP 4
Unplug and return cover cap to conceal motor head

REPLACE BATTERY



Twist the battery cover with coin/tool provided in the cradle, to Unlock and replace the battery negative side facing up.

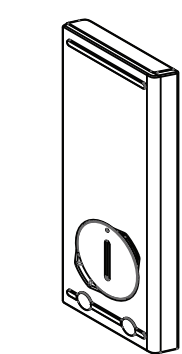
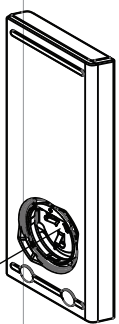

Replace the cover by turning the cover to the locked position

WALL MOUNTING

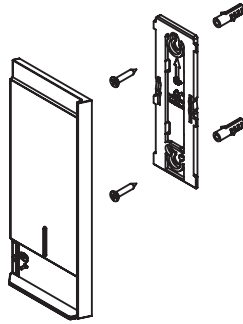

Use supplied fasteners and anchors to attach the base to wall.



INSTALLER

This setup wizard should be used for new installation or factory reset motors only. Individual steps may not work if you haven't followed the setup from the beginning.

INSTALLER

ON REMOTE

STEP 1.

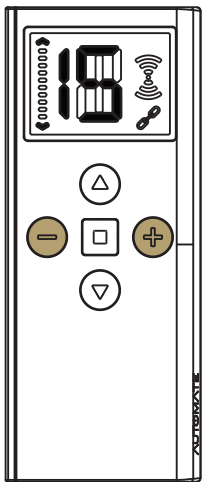

Select the desired channel you wish to program scrolling using the + or - Buttons

STEP 2.

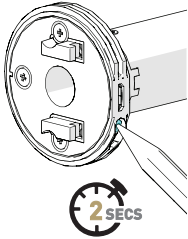

* Internal Tubular pictured. Refer to "P1 Locations" for specific devices

Press the P1 button on the motor for 2 Seconds until the motor responds as below

MOTOR RESPONSE



Within 4 seconds hold the stop button on the remote for 3 seconds. The motor will respond with Jog and Beep

MOTOR RESPONSE



CHECK DIRECTION

STEP 3.

Press up or down to check the motor direction. If correct skip to step 5.

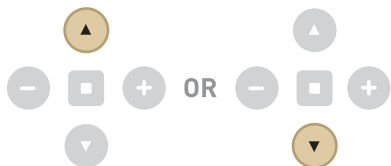

CHANGE DIRECTION

STEP 4.

If the shade direction needs to be reversed; press and hold the up & down arrow together for 5 seconds until the motor Jogs.



MOTOR RESPONSE



Reversing motor direction using this method is only possible during initial set-up.

SET TOP LIMIT

STEP 5.

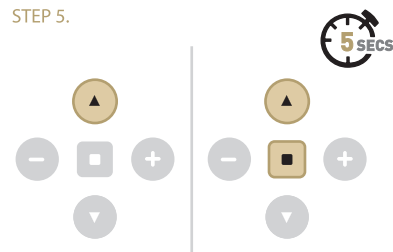

Move shade to desired top limit by pressing the up arrow repeatedly. Then press and hold up & stop together for 5 sec to save limit.

Tap the arrow several times or hold down if needed; press arrow to stop.

MOTOR RESPONSE



SET BOTTOM LIMIT

STEP 6.

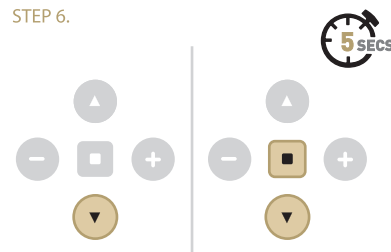

Move shade to desired bottom limit by pressing the down arrow repeatedly. Then press and hold down & stop together for 5 sec to save limit.

Tap the arrow several times or hold down if needed; press arrow to stop.

MOTOR RESPONSE



SAVE LIMIT

STEP 7.

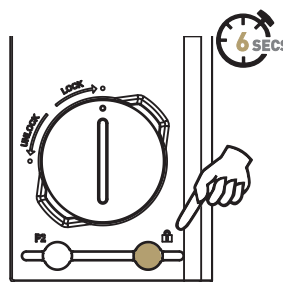

Repeat steps 1-6 for other motors. Once complete Press and hold the Lock button for 6 seconds while looking at the LED, and hold until L displayed.

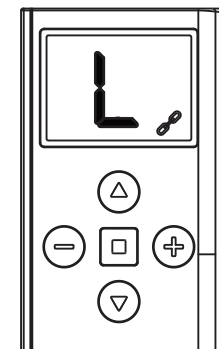

MOTOR RESET PROCEDURE

FACTORY RESET

To reset all settings in the motor press and hold the P1 Button for 14 seconds, you should see 4 independent jogs followed by 4x Beeps at the end.

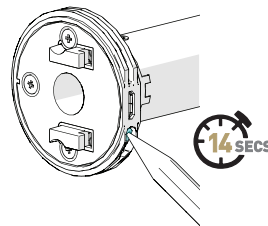

* Internal Tubular pictured above. Refer to "P1 Locations" for specific devices

MOTOR RESPONSE

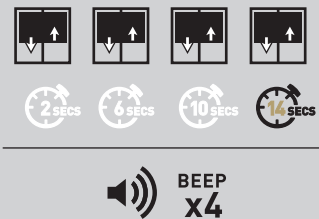



GROUP CHANNEL PROGRAMMING MODE

It is possible to add Individual Channels (1-15) to create Custom Group Channels (A-E)

STEP 1.

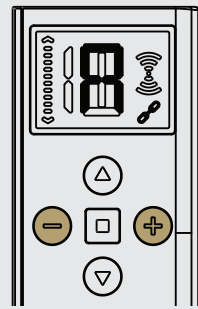

Select a Group Channel to program A-E

STEP 2.

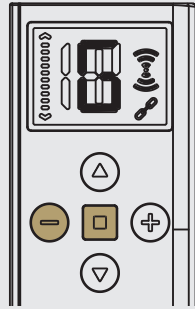

Hold (-) and STOP buttons for 4 seconds, during this time "G" will be displayed. Select a Group Channel to program A-E (If no buttons are pressed for 90 seconds the remote will exit out of this mode)

STEP 3.

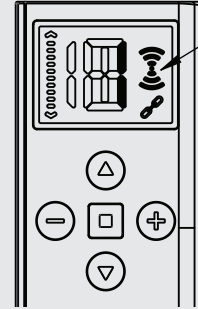

Remote is now in Group Channel Programming Mode. Signal Symbol will be shown and Individual Channel 1 will be displayed

STEP 4.

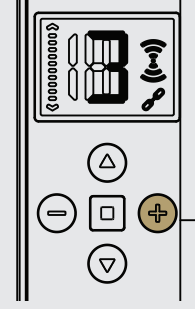

x3

Use (+) button to cycle to desired Individual Channel you want to add to that group (Channel 3 used as an example) **Note:** Only (+) button can be used to cycle through channels

STEP 5.



Use (-) button to toggle on/off the inclusion into the Group Channel **Note:** Group Channel Indicator will be shown to indicate Channel is added

STEP 6.

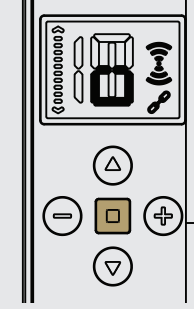

Once desired Individual Channels have been added, press the STOP button to confirm changes. The screen above will be shown for 4 seconds

STEP 7.

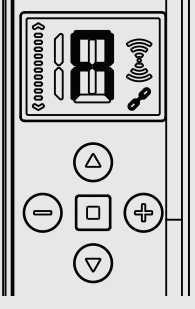

The remote has now returned to Normal Mode. The Group Channel is ready to use

GROUP CHANNEL VIEW MODE

STEP 1.

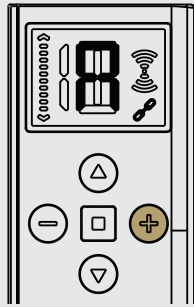

Cycle past Channel 1-15 and Select a Group Channel A-E to view

STEP 2.

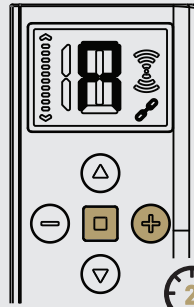

Once you are on the Groups Channels that you would like to view Hold (+) and STOP buttons for 2 seconds

STEP 3.

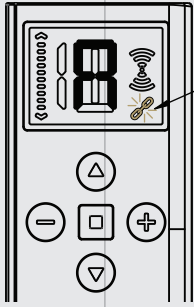

Remote is now in Group Channel Viewing Mode. Linked Symbol will flash and added Individual Channels will be displayed

STEP 4.

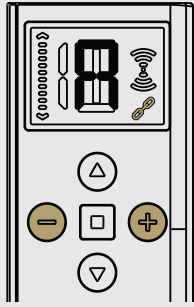

Use (+) and (-) buttons to scroll included channels.

STEP 5.

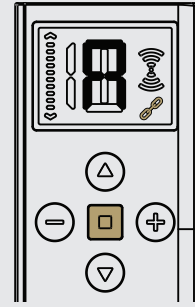

Press STOP to exit

LEVELING CONTROL FUNCTION

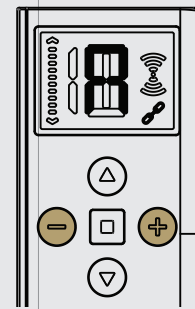

Select the desired Channel or Group you would like to control.

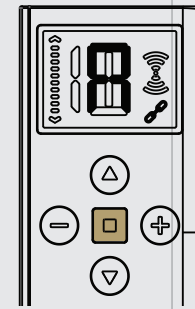

Double Tap the stop Button not the Level Control Bar. Now Press up or down to set the desired shade percentage. After 2 seconds the shade/s will move to that percentage.

CHANNEL OR GROUP SELECTION

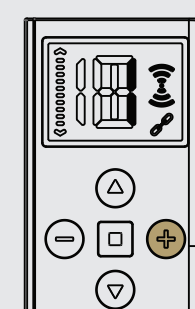

Press (+) to Cycle through Channels or groups.

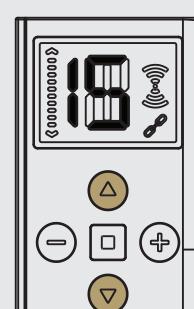

Once you selected the desired channel or group press Up and Down Buttons to send open or close commands

HIDE GROUPS

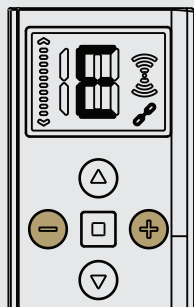

Hold Channel UP and DOWN for 5 seconds until "E" is displayed.

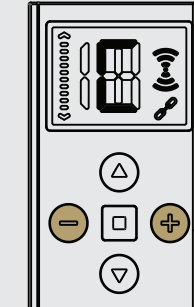

Select + or - and scroll through all channels that you want to hide

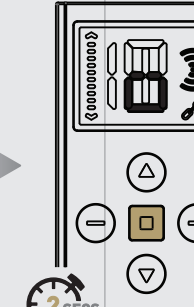

Press and hold STOP to confirm. The letter "o" will be displayed.

HIDE CHANNELS

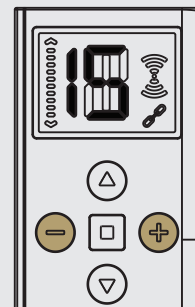

Hold Channel UP and DOWN for 5 seconds until 15 is displayed.



Select + or - and scroll through all channels that you want to hide

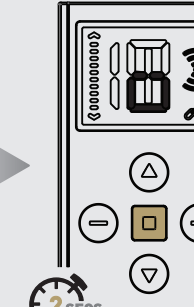

Press and hold STOP to confirm. The letter "o" will be displayed.

DISABLE LIMIT SETTING

This mode is intended to be used after all shade programming completed. User mode will prevent accidental or unintended changing of limits.

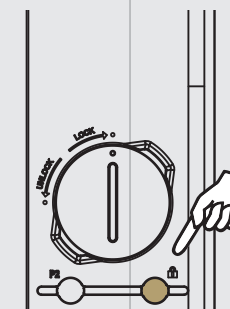

Push switch to lock or unlocked position.

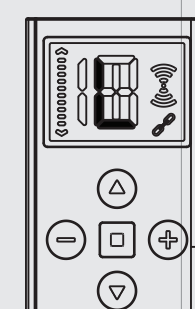

Pressing the lock button will toggle between locked and unlocked on LED screen.

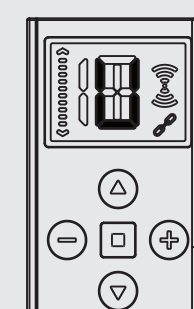

SET A FAVORITE POSITION

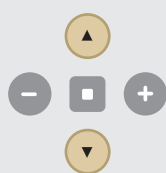

Move shade to desired position by pressing UP or DOWN on the remote.

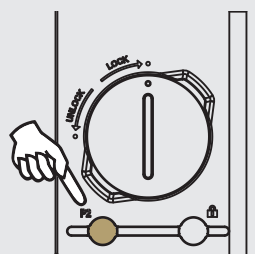

Press P2 on controller.

MOTOR RESPONSE



JOG X1



BEEP X1

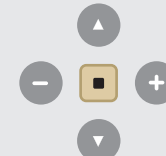

Press STOP on remote.

MOTOR RESPONSE



JOG X1

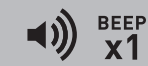

BEEP X1

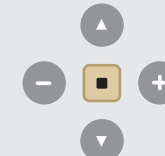

Press STOP on remote.

MOTOR RESPONSE



JOG X2



BEEP X3